

M6x1 depth 13
For power connection
Tightening torque : 10N.m MAX

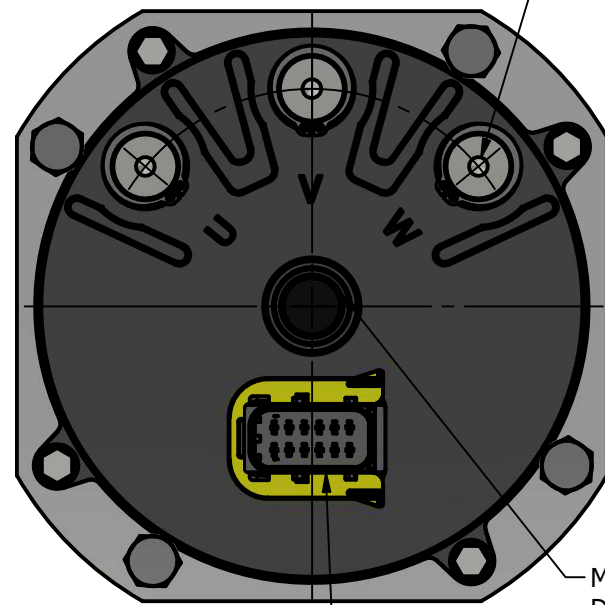

Membrane breather vent
Do not cover

TE HDSCS 12 pins
Male pins connector
P/N 1-1564520-1
Recommended mating part : 1-1703639-1

Ø82,7 G7
(82,747)
(82,712)

13,9

L1

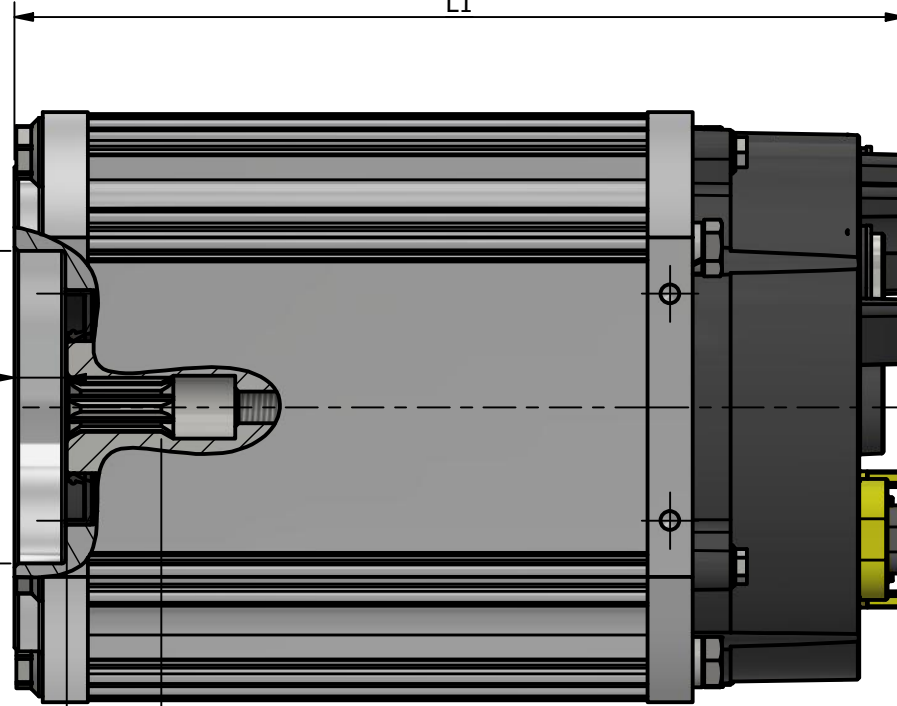

25

← F VIEW

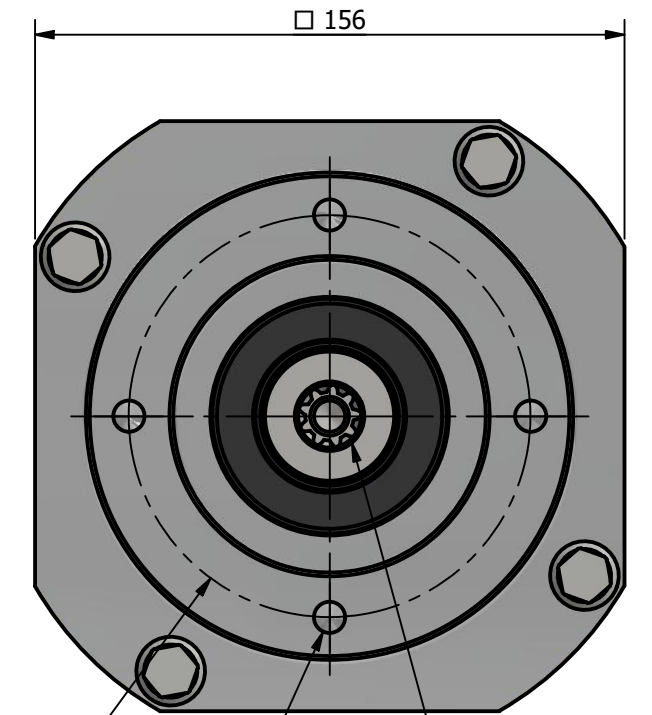

Ø106,4

4x M10x1.5 depth 15

Splines 16/32 9T
Flat root side fit

□ 156

8x M6x1 depth 15 on 4 sides
For mounting , lifting and grounding

60

L2

13,5

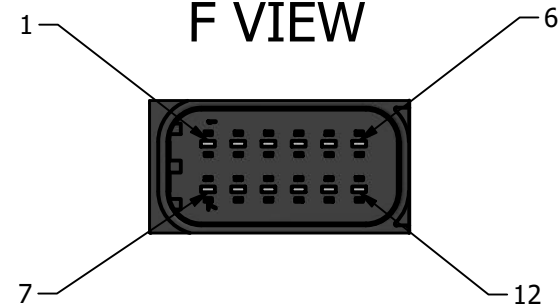
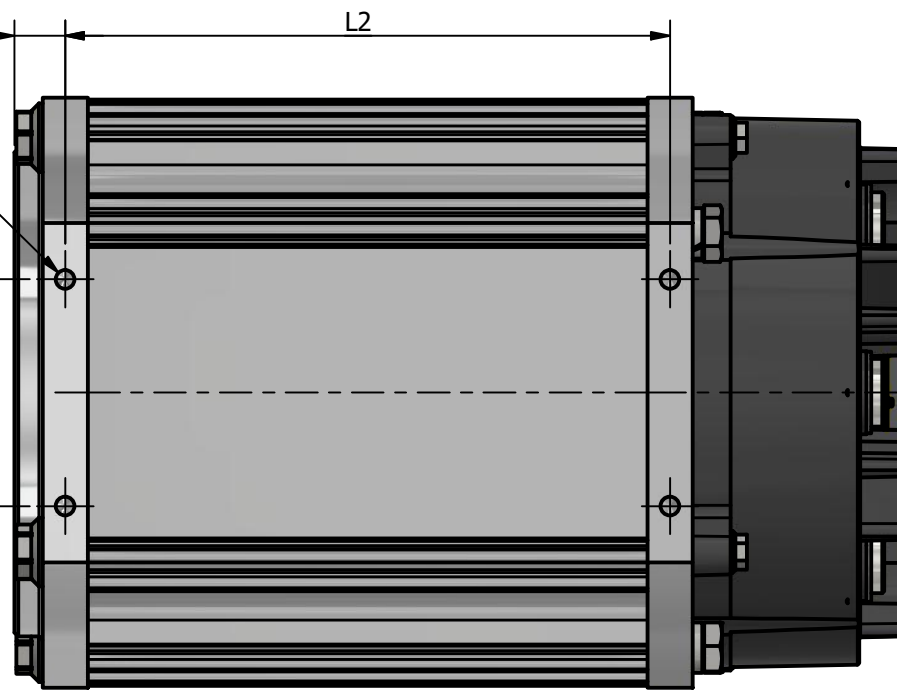

F VIEW

1

6

7

12

Feedback connector pin out (Male pins)

Pin	Function
1	VA
2	VB
3	VDD
4	GND
5	PT1000
6	PT1000

Motor data

Motor size	L1	L2	SAE A	Weight
NX820M	235.5	160	X	13 kg
NX840M	295.5	220	X	20,5 kg
NX860M	355.5	280	X	28 kg

SPLINE INTERFACE DATA

ANSI B92.1	SAE A
Flat root side fit	Class 6
Number of teeth	9
Spline Pitch	16/32
Pressure angle	30°
Base diameter (Ref)	Ø12.373
Pitch diameter (Ref)	Ø14.288
Major diameter (Max)	Ø16.535
Form diameter (Max)	Ø15.977
Minor diameter (Min)	Ø12.929
Circular space width (Max actual)	2.586
Circular space width (Min effective)	2.494

Drawing valid for : -

Folio : 1 / 1

Mass : Kg

General Tolerances

DIN ISO 2768 mk

Drawn	11/03/2022	TD	Visa
Modifications			
A	TCN2022-0185	21/10/22	AC



Scale



4 Bd Eiffel. CS 40090
21604 LONGVIC CEDEX

NX8M SAE A SIN/COS

OUTLINE DRAWING

Format A3

F	E	S	G	I
X				

345420E0001

A

THIS DOCUMENT CONTAINS INFORMATION THAT IS CONFIDENTIAL AND PROPRIETARY TO PARKER HANNIFIN CORPORATION. THIS DOCUMENT IS FURNISHED ON THE UNDERSTANDING THAT THE DOCUMENT AND THE INFORMATION IT CONTAINS WILL NOT BE COPIED OR DISCLOSED TO OTHERS OR USED FOR ANY PURPOSE OTHER THAN CONDUCTING BUSINESS WITH PARKER HANNIFIN CORPORATION, AND WILL BE RETURNED AND ALL FURTHER USE DISCONTINUED UPON REQUEST BY PARKER HANNIFIN CORPORATION. THE RECIPIENT OF THIS DOCUMENT THROUGH ITS OWN ANALYSIS AND TESTING IS SOLELY RESPONSIBLE FOR MAKING THE FINAL SELECTION OF THE APPLICABLE SYSTEM AND COMPONENTS AND ASSURING THAT ALL PERFORMANCE, ENDURANCE, MAINTENANCE, SAFETY AND WARNING REQUIREMENTS OF THE APPLICATION ARE MET. COPYRIGHT PARKER HANNIFIN CORPORATION. YEAR OF COPYRIGHT IS FIRST YEAR INDICATED ON THIS DOCUMENT. ALL RIGHTS RESERVED.